

STATE	PROJECT NO.	SHEET NO.	TOTAL SHEETS
N.C.	2025CPT.10.20.20041	1	
F.A. PROJECT NO.			

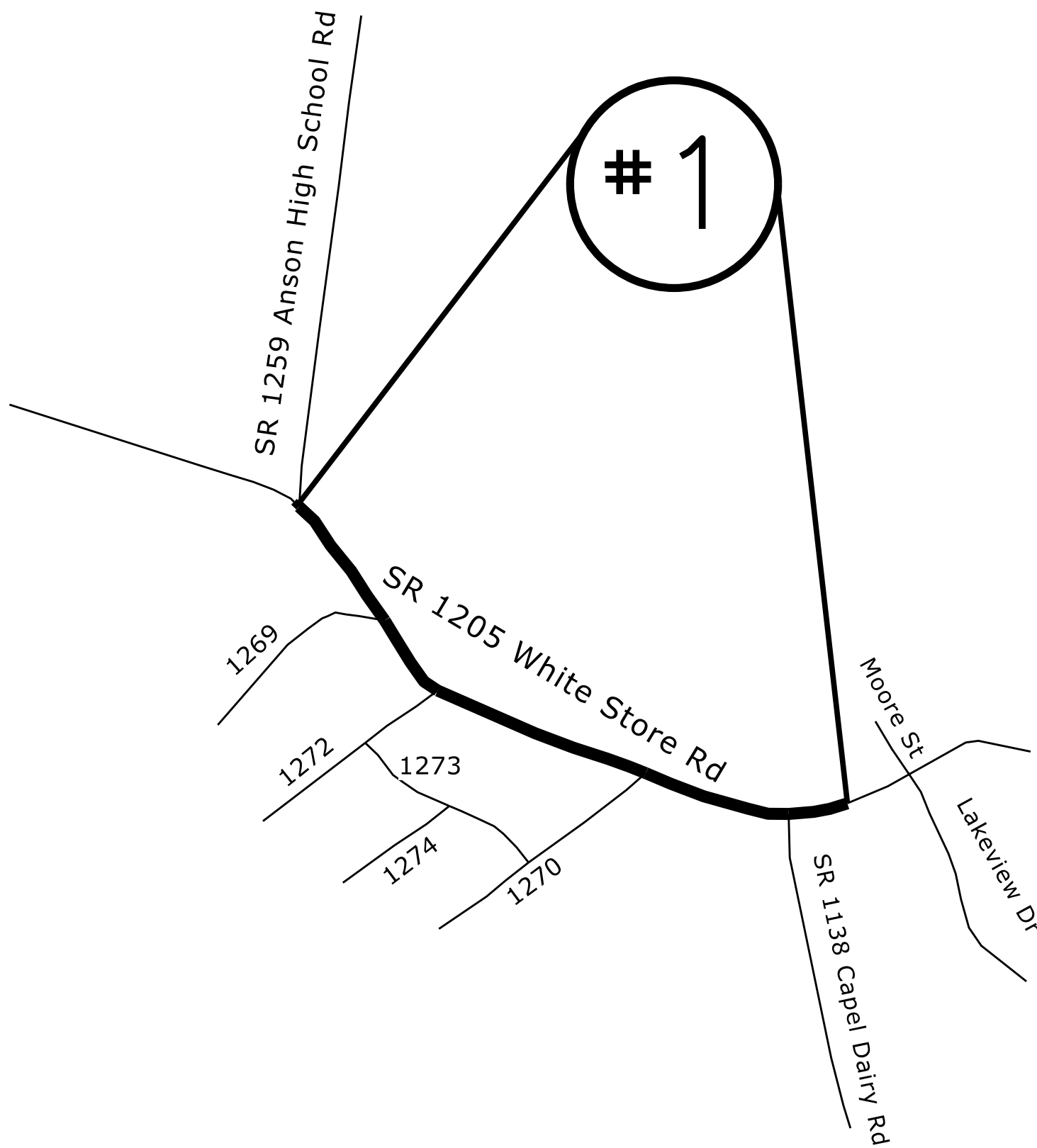

ENLARGED MUNICIPAL AND SUBURBAN AREAS
ANSON COUNTY
 NORTH CAROLINA
PREPARED BY THE
 NORTH CAROLINA DEPARTMENT OF TRANSPORTATION
 DIVISION OF HIGHWAYS - DIVISION 10 DISTRICT 3

MAP #1 SR 1205 WHITE STORE RD
 .58 MILES
 FROM SR 1259 ANSON HIGH SCHOOL RD
 TO PVMT JOINT AT WADESBORO CITY LIMITS

STATE	PROJECT NO.	SHEET NO.	TOTAL SHEETS
N.C.	2025CPT.10.20.20041	2	
F.A. PROJECT NO.			

#2



ENLARGED MUNICIPAL AND SUBURBAN AREAS
ANSON COUNTY
 NORTH CAROLINA
PREPARED BY THE
 NORTH CAROLINA DEPARTMENT OF TRANSPORTATION
 DIVISION OF HIGHWAYS - DIVISION 10 DISTRICT 3

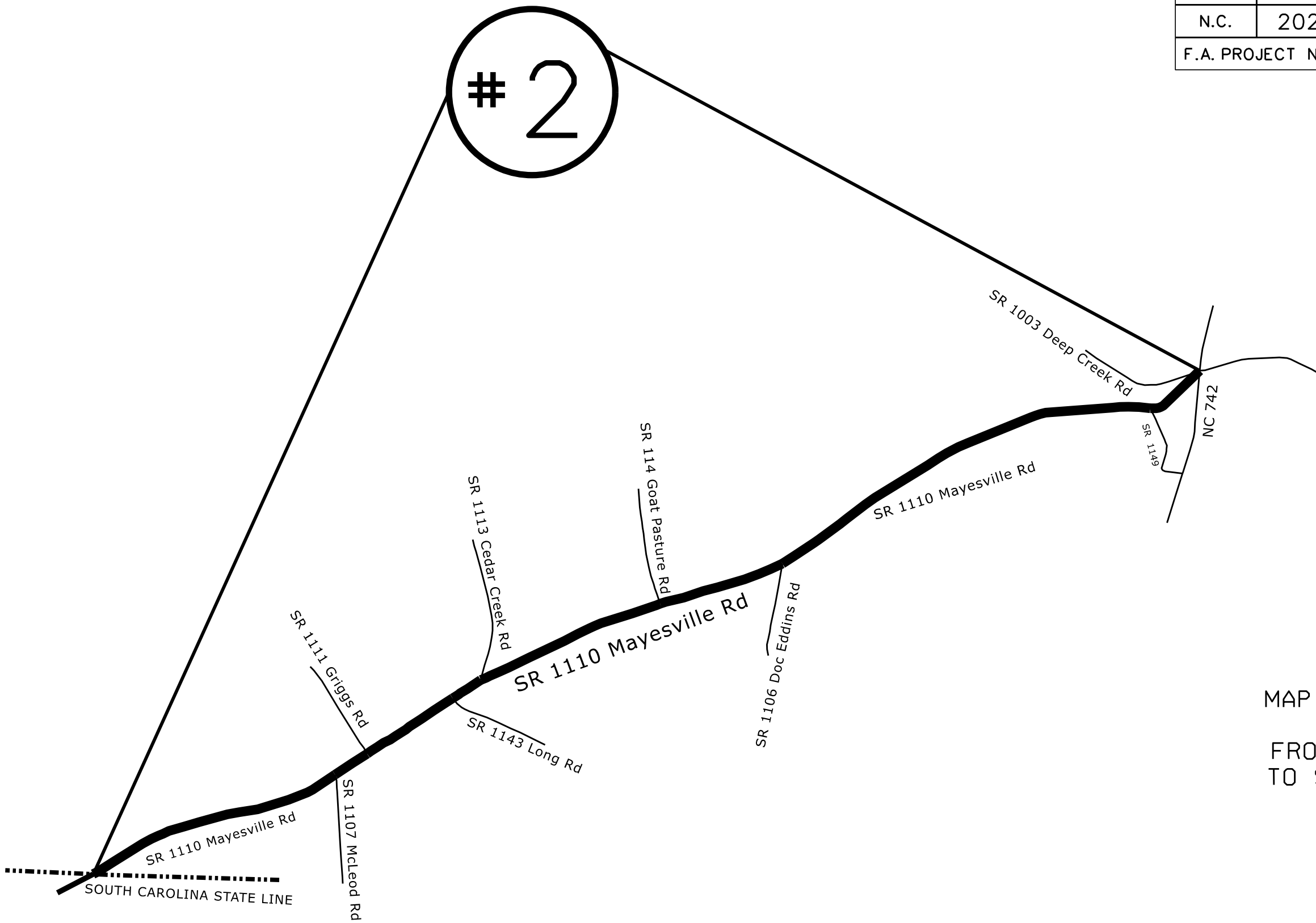

MAP #2 SR 1110 MAYESVILLE RD
 4.55 MILES
 FROM SR 1003 DEEP CREEK RD
 TO SOUTH CAROLINA STATE LINE

STATE	PROJECT NO.	SHEET NO.	TOTAL SHEETS
N.C.	2025CPT.10.20.20041	3	
F.A. PROJECT NO.			

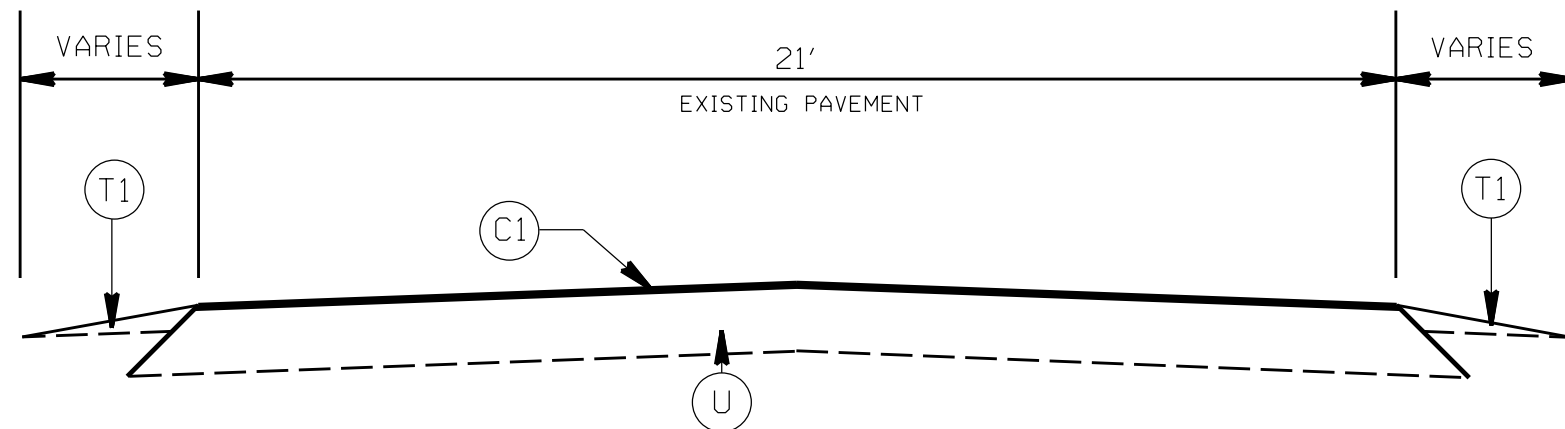

TYPICAL SECTION NO. 1
SR 1205 WHITE STORE RD (MAP 1)

PAVEMENT SCHEDULE

(C1)	PROP. APPROX. 1.5" ASPHALT CONC. SURFACE COURSE, TYPE S9.5C, AT AN AVERAGE RATE OF 168 LBS. PER SQ. YD.
(E1)	PROPOSED 5.0" ASPHALT CONC. BASE COURSE, TYPE B25.0C, AT AN AVERAGE RATE OF 570 LBS. PER SQ. YD.
(T1)	SHOULDER RECONSTRUCTION
(U)	EXISTING PAVEMENT

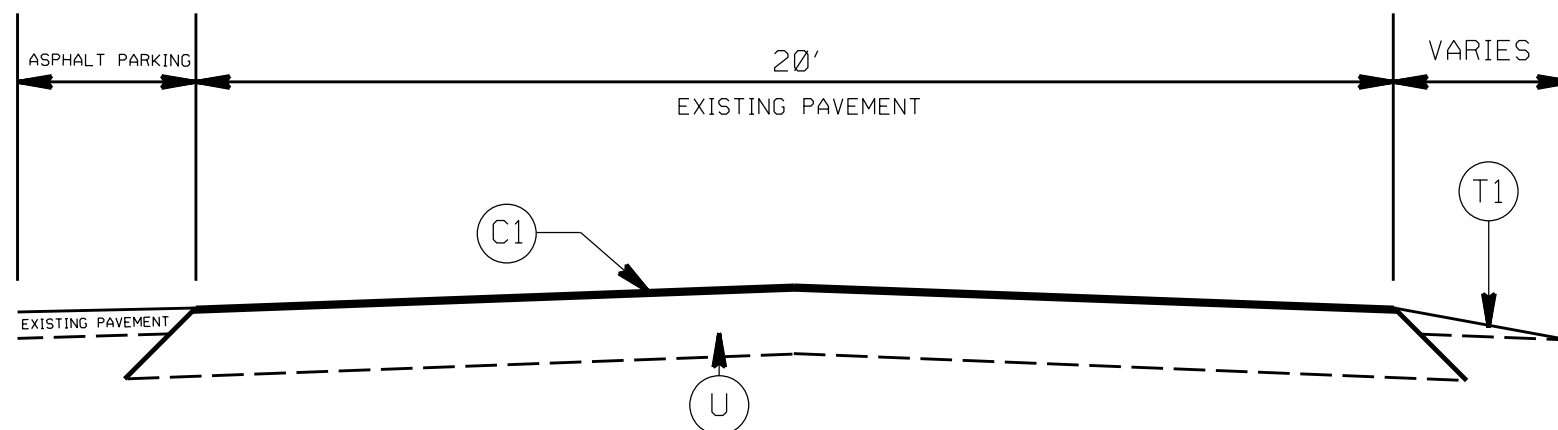

TYPICAL SECTION NO. 2
SR 1110 MAYESVILLE RD (MAP 2)
STA. 10+00 TO 12+60

2025
ANSON COUNTY RESURFACING

SCALE	NA
DATE	7/21
DWG. BY	AMO
DESIGN BY	AMO
APPROVED	

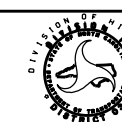

REVISIONS

STATE	PROJECT NO.	SHEET NO.	TOTAL SHEETS
N.C.	2025CPT.10.20.20041	4	
F.A. PROJECT NO.			

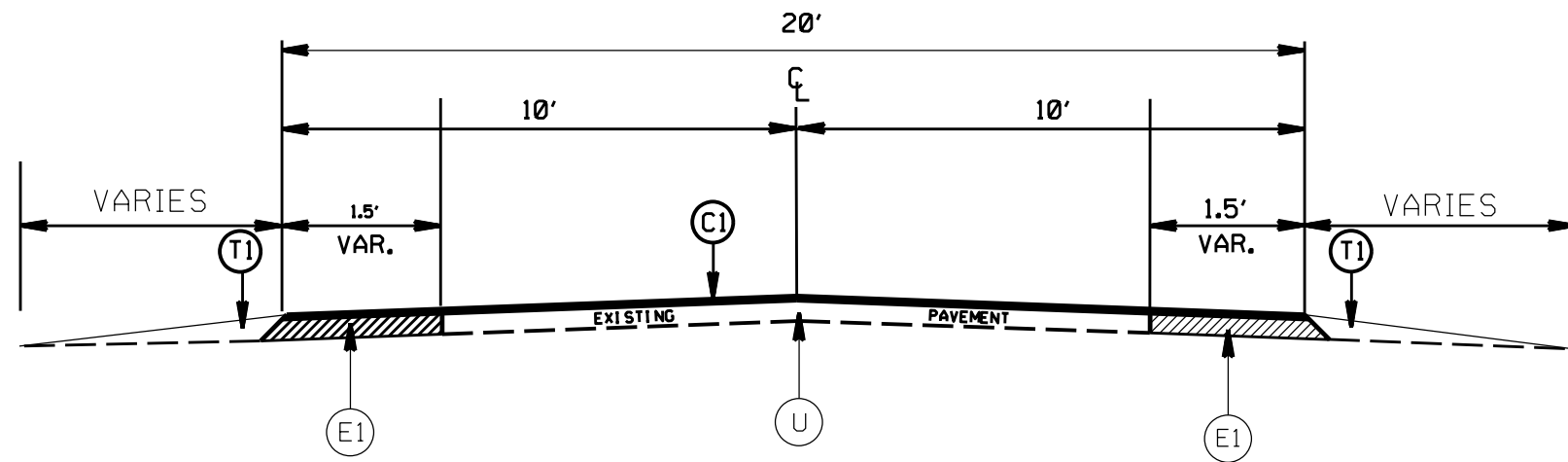

PAVEMENT SCHEDULE

(C1)	PROP. APPROX. 1.5" ASPHALT CONC. SURFACE COURSE, TYPE S9.5C, AT AN AVERAGE RATE OF 168 LBS. PER SQ. YD.
(E1)	PROPOSED 5.0" ASPHALT CONC. BASE COURSE, TYPE B25.0C, AT AN AVERAGE RATE OF 570 LBS. PER SQ. YD.
(T1)	SHOULDER RECONSTRUCTION
(U)	EXISTING PAVEMENT

TYPICAL SECTION NO. 3
 SR 1110 MAYESVILLE RD (MAP 2)
 STA. 12+60 TO 250+24

2025
 ANSON COUNTY RESURFACING

SCALE	-NA-		REVISIONS
DATE	7/21		
DWG. BY	AWD		
DESIGN BY	AWD		
APPROVED			

STATE	PROJECT NO.	SHEET NO.	TOTAL SHEETS
N.C.	2025CPT.10.20.20041	5	
F.A. PROJECT NO.			

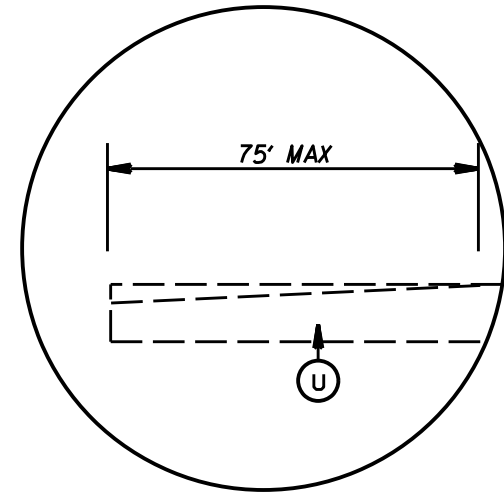

DETAIL FOR INCIDENTAL MILLING (0" TO 1.5")

PAVEMENT SCHEDULE

(C1)	PROP. APPROX. 1.5" ASPHALT CONC. SURFACE COURSE, TYPE S9.5C, AT AN AVERAGE RATE OF 168 LBS. PER SQ. YD.
(E1)	PROPOSED 5.0" ASPHALT CONC. BASE COURSE, TYPE B25.0C, AT AN AVERAGE RATE OF 570 LBS. PER SQ. YD.
(T1)	SHOULDER RECONSTRUCTION
(U)	EXISTING PAVEMENT

PATCHING DETAIL

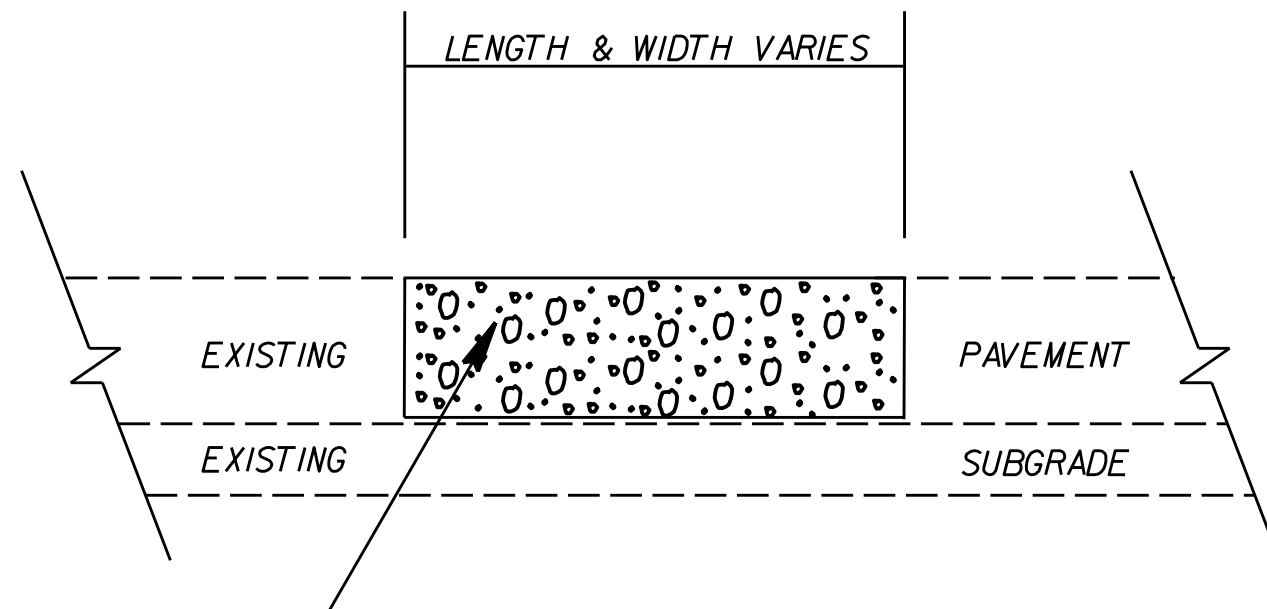

RATE IS VARIABLE AND SHALL BE AS DIRECTED BY THE ENGINEER. ASPHALT TYPE 119.0C SHALL BE PLACED.

2025
ANSON COUNTY RESURFACING

SCALE	-NA-		REVISIONS
DATE	7/21		
DWG. BY	AJB		
DESIGN BY	AJB		
APPROVED			

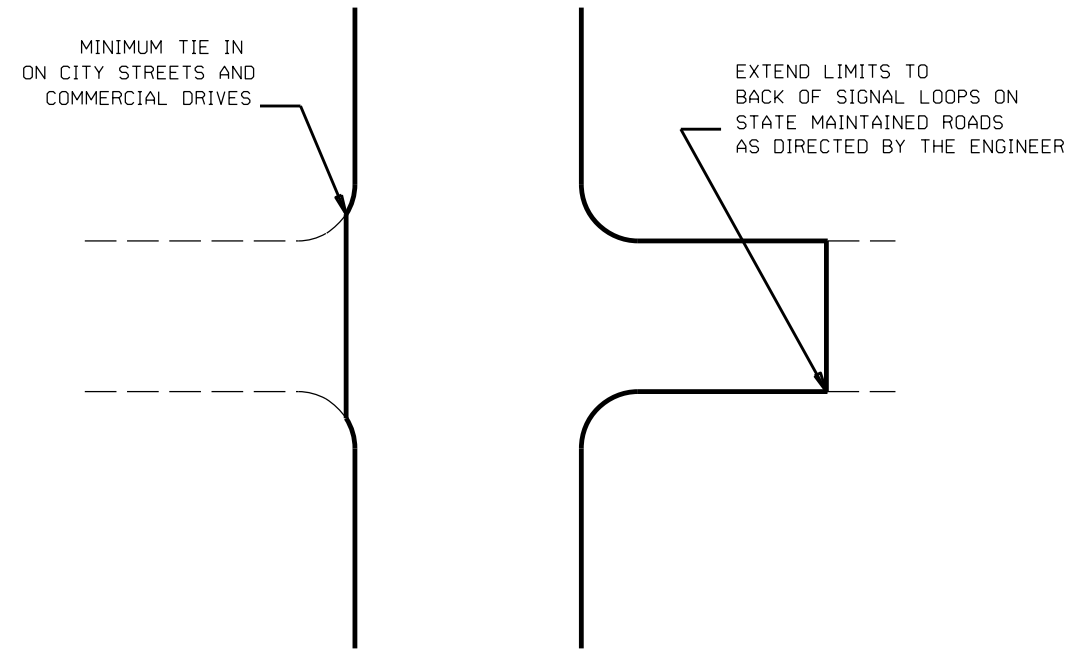

TYPICAL DETAIL OF PROJECT LIMITS AT SIGNALIZED Y LINES

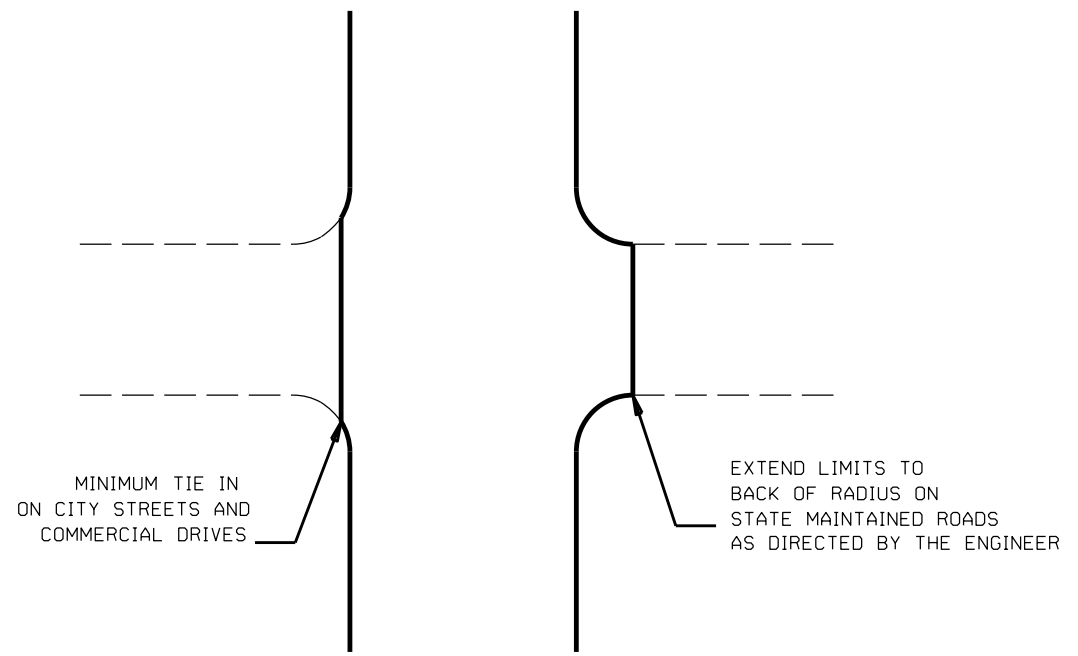

TYPICAL DETAIL OF PROJECT LIMITS AT UNSIGNALIZED Y LINES

ADDITIONAL INTERSECTIONS (NON-TYPICAL)		
Extend paving limits to back of radius or loop on the following intersections:		
MAP#	STREET NAME	COMMENTS
MAP 1	BILLOW ST SR 1269	TO PMVT JOINT
MAP 1	RIVER DR SR 1272	
MAP 1	FAULKER MHP RD SR 1270	TO PMVT JOINT
MAP 1	CAPEL DAIRY RD SR 1138	TO PMVT JOINT
MAP 2	MCLEOD RD SR 1107	TO PMVT JOINT
MAP 2	GRIGGS RD SR 1111	
MAP 2	LONG RD SR 1143	
MAP 2	CEDER CREEK RD SR 1113	
MAP 2	GOAT PASTURE RD SR 1114	
MAP 2	DOC EDDINGS RD SR 1106	
MAP 2	EDDINGS RD SR 1149	TO PMVT JOINT

2025
ANSON COUNTY RESURFACING

SCALE	1/2"		REVISIONS
DATE	7/27		
DESIGNED BY	AJB		
APPROVED			

STATE	PROJECT NO.	SHEET NO.	TOTAL SHEETS
N.C.	2025CPT.10.20.20041	7	
F.A. PROJECT NO.			

PROJECT NOTES:

1. DEPTH OF PATCHING WILL BE AS DIRECTED BY THE ENGINEER.

2. SHOULDER RECONSTRUCTION WILL BE AS DIRECTED BY THE ENGINEER.

2025
ANSON COUNTY RESURFACING

SCALE	NA		REVISIONS	
DATE	7/21			
DWG. BY	AJB			
DESIGN BY	AJB			
APPROVED				

NOTES:

- 1) DETAIL DOES NOT APPLY TO OGAFCC AND ULTRA-THIN BONDED WEARING COURSE.
- 2) BACKFILL SHOULDER WITH APPROVED MATERIAL.
- 3) THE SHOULDER WEDGE DEVICE MAY BE DISENGAGED AT PAVED DRIVEWAYS AND SIDE STREETS.

STATE	PROJECT NO.	SHEET NO.	TOTAL SHEETS
N.C.	2025CPT.10.20.20041	8	
F.A. PROJECT NO.			

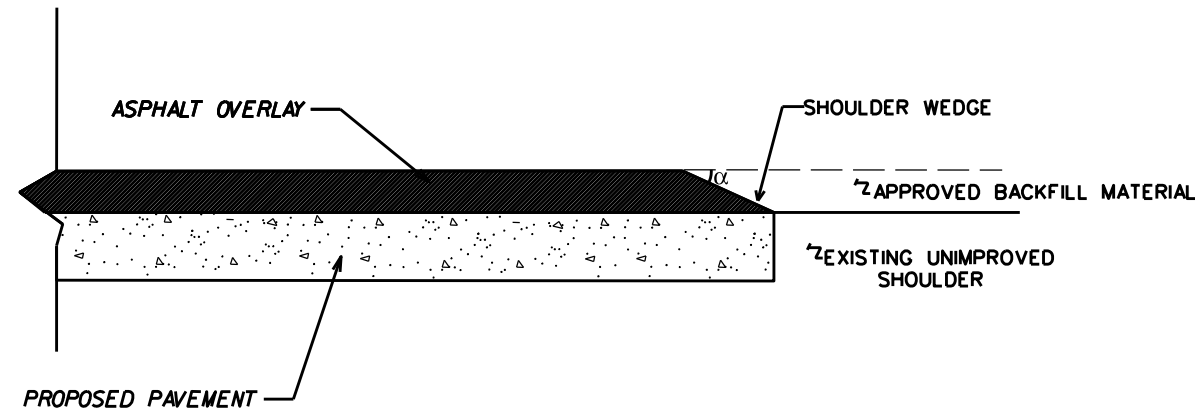

SHOULDER WEDGE DETAIL

(RESURFACING PROJECTS W/ WIDENING OR WITH EXISTING PAVED SHOULDER HAVING NO DROPOFFS)

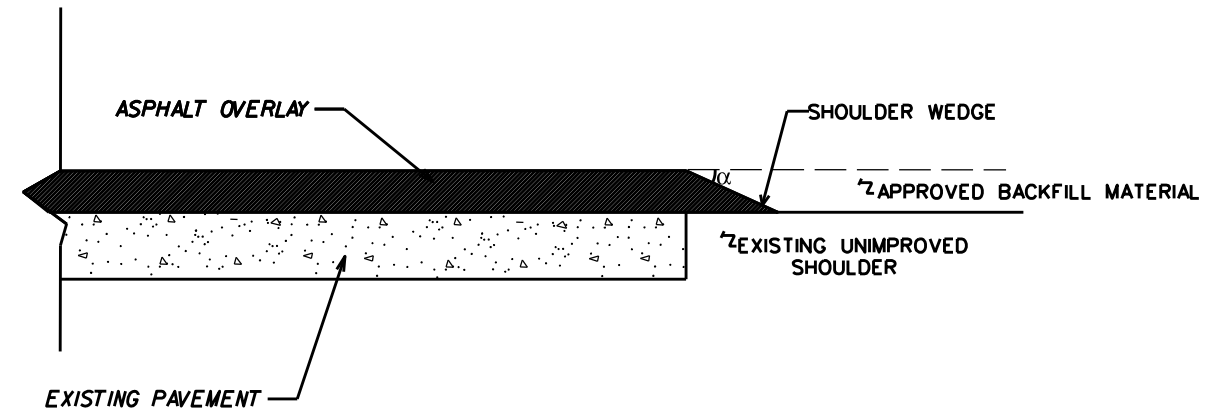

SHOULDER WEDGE DETAIL

(RESURFACING PROJECTS W/ NO WIDENING)

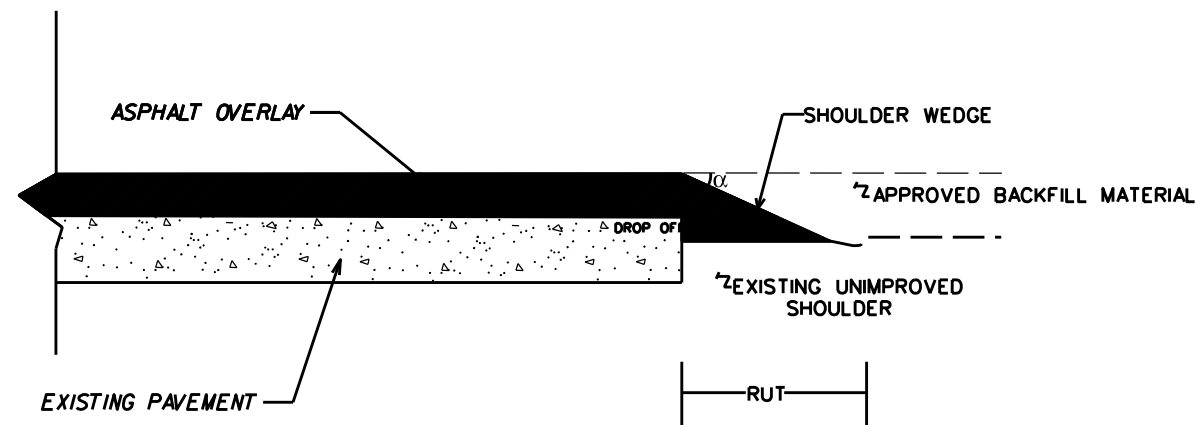

SHOULDER WEDGE DETAIL
(RESURFACING ADJACENT TO RUTTED SHOULDER)

$\alpha = 30$ DEGREES

SHOULDER WEDGE DETAILS		
SCALE	1/4"	REVISIONS
DATE	7/21	
DWG. BY	AJB	
DESIGN BY	AJB	
APPROVED		



WATTLE WITH POLYACRYLAMIDE DETAIL

STATE	PROJECT NO.	SHEET NO.	TOTAL SHEETS
N.C.	2025CPT.10.20.20041	EC1	
F.A. PROJECT NO.			

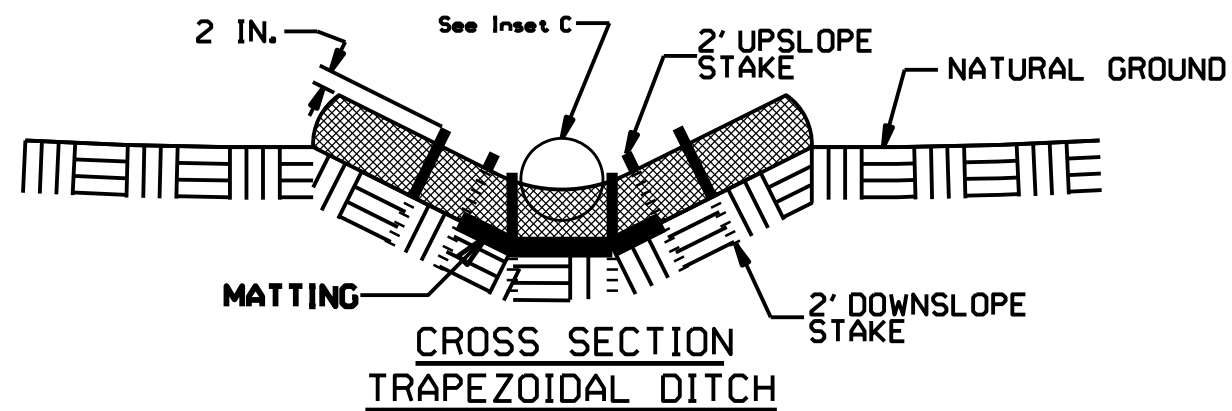
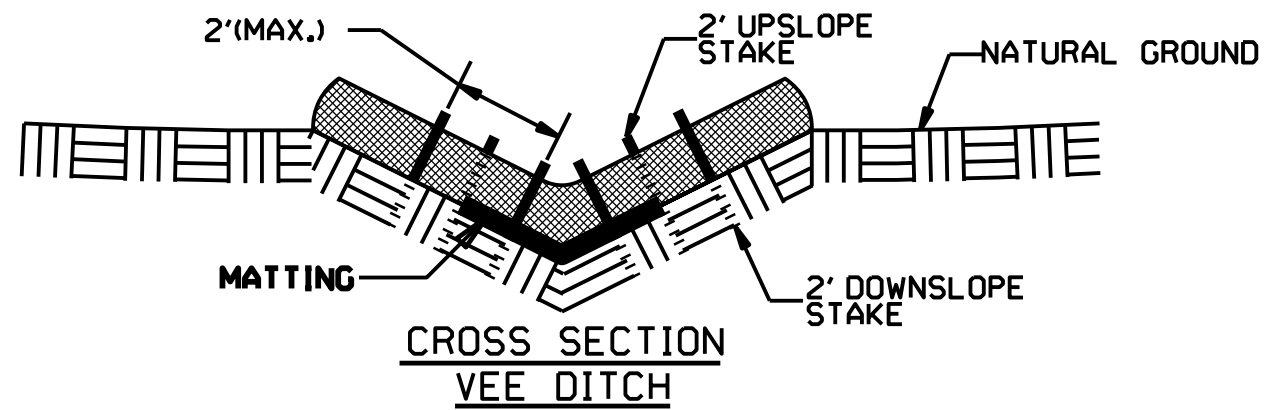
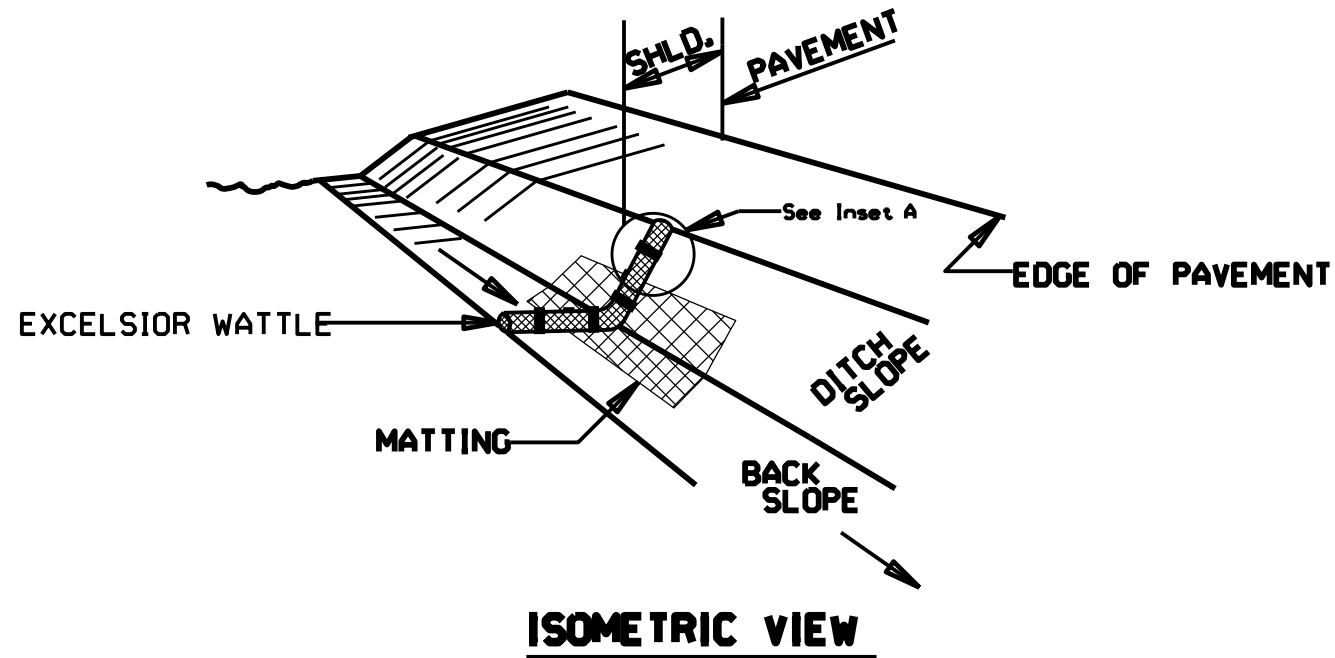

NOTES:

USE MINIMUM 12 IN. DIAMETER EXCELSIOR WATTLE.

USE 2 FT. WOODEN STAKES WITH A 2 IN. BY 2 IN. CROSS SECTION.

INSTALL A MINIMUM OF 2 UPSLOPE STAKES AND 4 DOWNSLOPE STAKES AT AN ANGLE TO WEDGE WATTLE TO BOTTOM OF DITCH.

PROVIDE STAPLES MADE OF 0.125 IN. DIAMETER STEEL WIRE FORMED INTO A U SHAPE NOT LESS THAN 12" IN LENGTH.

INSTALL STAPLES APPROXIMATELY EVERY 1 LINEAR FOOT ON BOTH SIDES OF WATTLE AND AT EACH END TO SECURE IT TO THE SOIL.

INSTALL MATTING IN ACCORDANCE WITH SECTION 1631 OF THE STANDARD SPECIFICATIONS.

PRIOR TO POLYACRYLAMIDE (PAM) APPLICATION, OBTAIN A SOIL SAMPLE FROM PROJECT LOCATION, AND FROM OFFSITE MATERIAL, AND ANALYZE FOR APPROPRIATE PAM FLOCCULANT TO BE APPLIED TO EACH WATTLE.

INITIALLY APPLY 3.5 OUNCES OF ANIONIC OR NEUTRALLY CHARGED POLYACRYLAMIDE (PAM) OVER WATTLE WHERE WATER WILL FLOW AND AFTER EVERY RAINFALL EVENT THAT IS EQUAL TO OR EXCEEDS 0.50 IN.

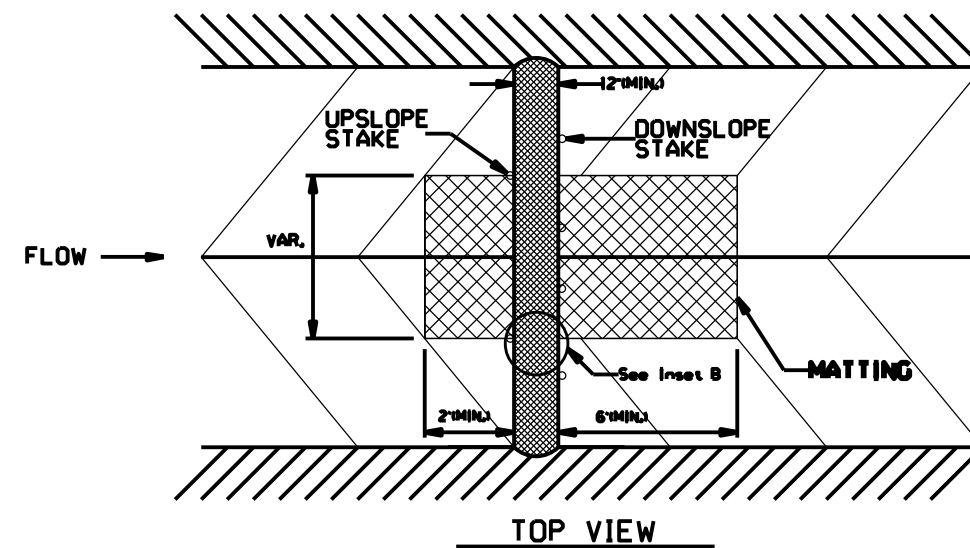
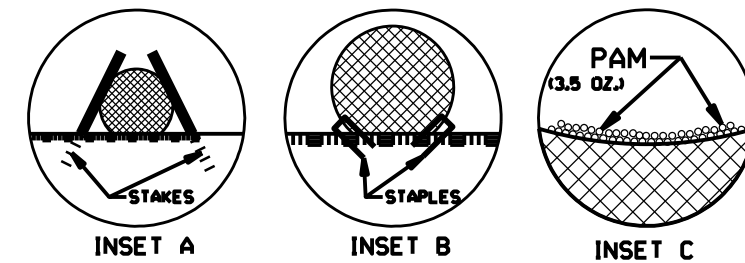

<i>EROSION CONTROL DETAIL</i>		
SCALE	-NA-	
DATE	1/20	
DWG. BY	AJB	
DESIGN BY	AJB	
APPROVED		REVISIONS

NOTES: LESS THAN 5' - 10' UNDISTURBED BUFFER FROM ROW, DITCHLINE, WATER FEATURE, OR DRAINAGE INLET, ADD BMP.

BMP OPTIONS: WATTLE OR SILT FENCE

STATE	PROJECT NO.	SHEET NO.	TOTAL SHEETS
N.C.	2025CPT.10.20.20041	EC2	
F.A. PROJECT NO.			

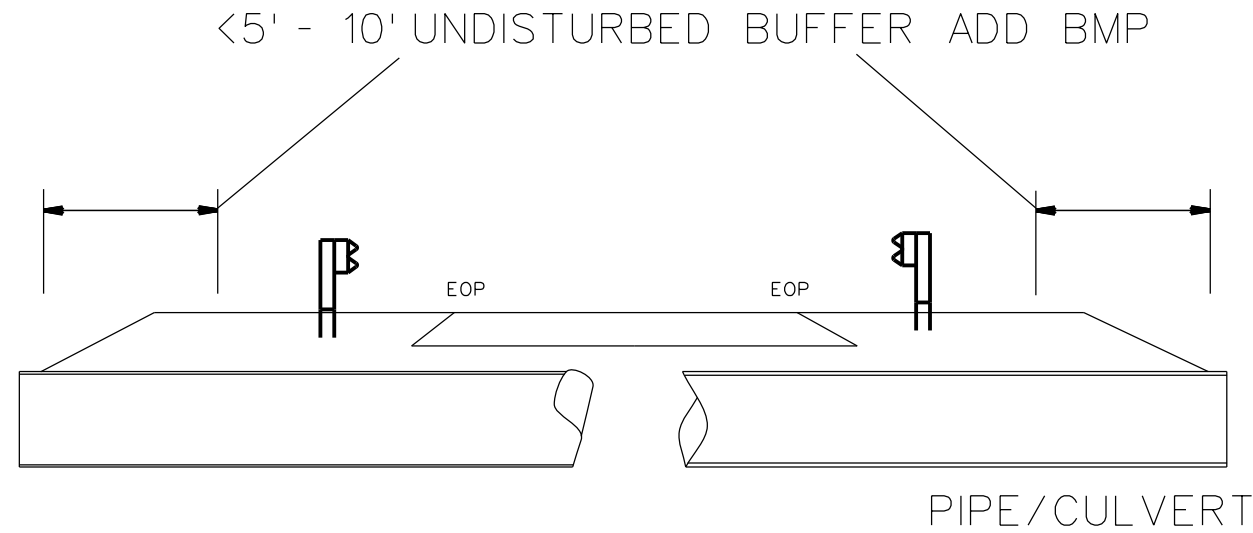

<5' - 10' UNDISTURBED BUFFER FROM JURISDICTIONAL FEATURE ADD BMP

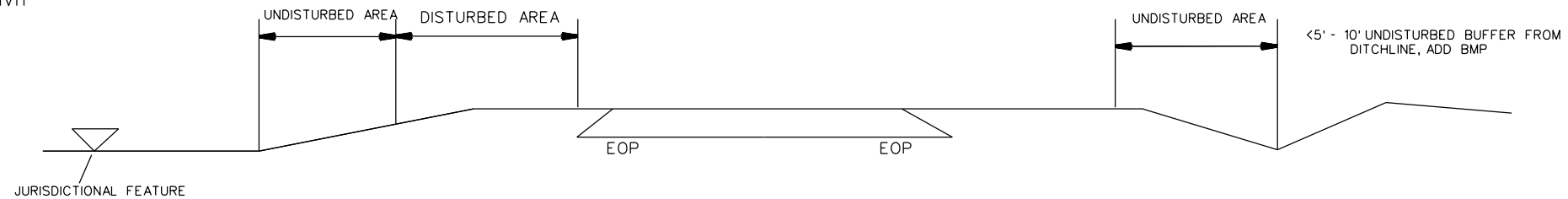

USE BMP'S IF SHOULDERS AND/OR FRONTSLOPES AND/OR DITCHLINE AND/OR BACKSLOPES ARE DISTURBED

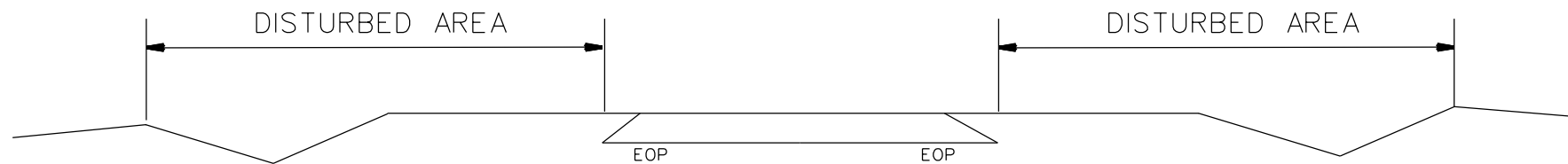

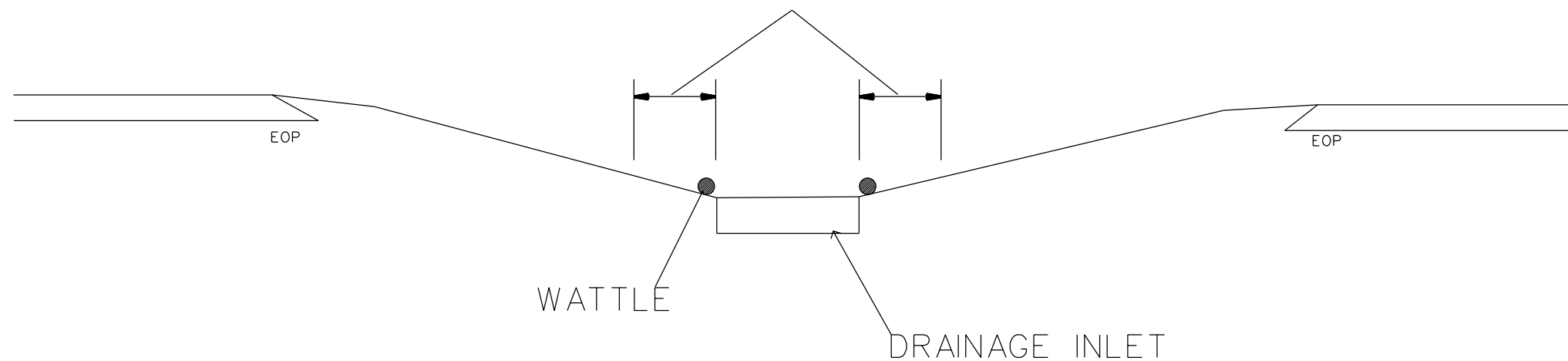

<5' - 10' UNDISTURBED BUFFER FROM INLET, ADD WATTLE



EROSION CONTROL DETAIL

SCALE	NA		REVISIONS
DATE	1/20		
DWG. BY	AJB		
DESIGN BY	AJB		
APPROVED			

SIGNING FOR RESURFACING PROJECTS

LEGEND
 STATIONARY SIGN
 DIRECTION OF TRAFFIC FLOW

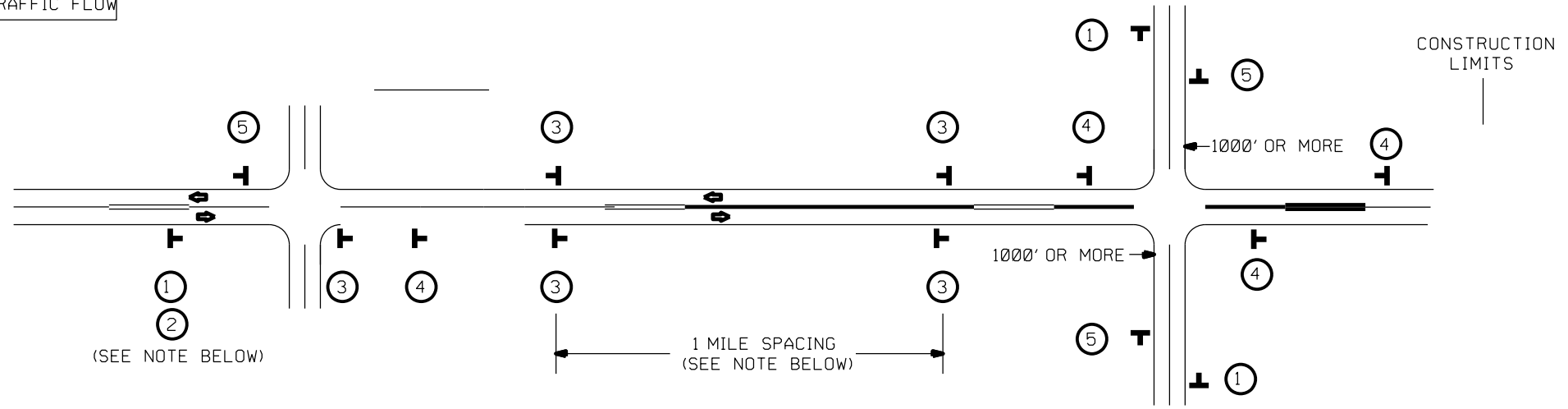

(SEE NOTE BELOW)

1 MILE SPACING
(SEE NOTE BELOW)

1000' OR MORE

CONSTRUCTION LIMITS

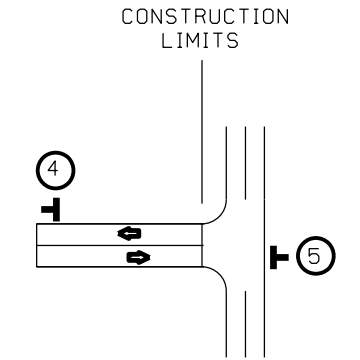

TEE INTERSECTION

MAINLINE (-L-) SIGNING

-Y- LINE SIGNING

SIGNING NOTES AND PLACEMENT PER DIRECTION	①		PLACE 1000' PRIOR TO BEGINNING OF CONSTRUCTION LIMITS. ONLY USED ON -Y- LINES IF RESURFACING LIMITS EXTEND 1000' ALONG -Y- LINE.	NO REQUIRED STATIONARY SIGNING FOR THE FOLLOWING -Y- LINE CONDITIONS: 1) LESS THAN 1000' OF RESURFACING ALONG -Y- LINE 2) SUBDIVISION ROADS 3) DEAD END ROADS
	②			
	③			
	④	 - THESE ARE FOR -Y- LINES THAT ARE "THROUGH" ROADWAYS. - DEAD END AND SUBDIVISION ROADS ARE NOT "THROUGH" ROADWAYS. - INSTALL 500' +/- FROM EACH -Y- LINE APPROACH AS SHOWN ABOVE. - FOR MULTIPLE -Y- LINES THAT ARE SEPARATED BY 0.25 MILES OR LESS, TREAT AS A SINGLE UNIT AND INSTALL WITHIN 500' OF EACH APPROACH. - A MAXIMUM OF 2 SIGN SETS PER MILE. DO NOT INSTALL WHEN -Y- LINES ARE WITHIN 0.5 MILES FROM "END ROAD WORK" SIGN. - FOR TEE INTERSECTIONS, INSTALL WITHIN 500' +/- OF THE INTERSECTION ALONG -L- LINE.	 	
⑤		PLACE 500' FOLLOWING THE END OF CONSTRUCTION LIMITS OR AS SHOWN WHEN WORK ENDS AT A 3-WAY TEE INTERSECTION.		

MAPS LESS THAN 2 MILES
 FOR RESURFACING MAPS WITH CONSTRUCTION LIMITS LESS THAN 2 MILES IN LENGTH, NO STATIONARY SIGNS ARE REQUIRED. USE PORTABLE "ROAD UNDER CONSTRUCTION" OR "ROAD WORK AHEAD" SIGNS IN LIEU OF STATIONARY ADVANCE WARNINGS SIGNS.

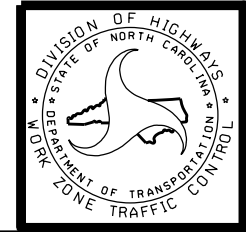

ADVANCE WARNING SIGNS FOR RURAL AND SUBURBAN 2-LANE ROADWAY RESURFACING

PROJECT NO.	SHEET NO.	TOTAL NO.
2025CPT.10.20.20041	SOQ 1	

SUMMARY OF QUANTITIES

PROJECT NO	COUNT	MAP NO	ROUTE	DESCRIPTION	TYP NO	LANES	LANE TYPE	FINAL SURFACE TESTING REQUIRED	WARM MIX ASPHALT REQUIRE	LENGT H MI	WIDT H FT	BEGIN MP	END MP	1220000000-E	1245000000-E	1260000000-E	1330000000-E	1491000000-E	1523000000-E	1524000000-E	1575000000-E	1704000000-E	2612000000-E	6000000000-E	6071002000-E	6071010000-E	
														INCIDENTAL STONE BASE	SHOULDER RECONSTRUCTION	AGGREGATE SHOULDER BORROW	INCIDENTAL MILLING	BASE COURSE, B25.0C	SURFACE COURSE, S9.5C	LEVELING COURSE, S9.5C	ASPHALT BINDER FOR PLANT MIX	PATCHING EXISTING PAVEMENT	6" DRIVEWAYS	TEMPORARY SILT FENCE	FLOCCULANT	WATTLE	
														TONS	SMI	TON	SY	TONS	TONS	TONS	TONS	TONS	TONS	SY	LF	LB	LF
2025CPT.10.20.20041	Anson	1	SR-1205 / WHITE STORE RD ROUTE ID # 40001205004	FROM SR 1259 ANSON HIGH SCHOOL RD TO WADESBORO CITY LIMITS MP 4.14 TO MP 4.72	1	2	2WU	NO	NO	0.58	21	4.14	4.72	50	1.16	161	627		740	203	75	400		87		87	
TOTAL FOR MAP NO. 1														50	1.16	161	627		740	203	75	400		87		87	
2025CPT.10.20.20041	Anson	2	SR-1110 / MAYESVILLE RD ROUTE ID # 40001110004	FROM SR 1003 DEEP CREEK RD TO SOUTH CAROLINA STATE LINE MP 0.00 TO MP 4.55	2,3	2	2WU	NO	NO	4.55	17-20	0	4.55	145	9.10	1,261	556	2,571	5,093	2,048	635	2,048	90	1,365	2	683	
TOTAL FOR MAP NO. 2														145	9.10	1,261	556	2,571	5,093	2,048	635	2,048	90	1,365	2	683	
TOTAL FOR PROJ NO. 2025CPT.10.20.20041														195	10.26	1,422	1,183	2,571	5,833	2,251	710	2,448	90	1,452	2	770	
GRAND TOTAL														195	10.26	1,422	1,183	2,571	5,833	2,251	710	2,448	90	1,452	2	770	

PROJECT NO.	SHEET NO.	TOTAL NO.
2025CPT.10.20.20041	SOQ 2	

THERMOPLASTIC AND PAINT QUANTITIES

PROJECT NO	COUNT Y	MAP NO	ROUTE	DESCRIPTION	TYP NO	LANES	LANE TYPE	LENGTH	WIDTH	BEGIN MP	END MP	4413000000-E	4457000000-N	4810000000-E	4810000000-E
								MI	FT			WORK ZONE ADVANCE/GENERAL WARNING SIGNING	TEMPORARY TRAFFIC CONTROL	4" WHITE PAINT	4" YELLOW PAINT
2025CPT.10.20.20041	Anson	1	SR-1205 / WHITE STORE RD ROUTE ID # 40001205004	FROM SR 1259 ANSON HIGH SCHOOL RD TO WADESBORO CITY LIMITS MP 4.14 TO MP 4.72	1	2	2WU	0.58	21	4.14	4.72	65	0.15	12,448	12,448
TOTAL FOR MAP NO. 1							0.58					65	0.15	12,448	12,448
2025CPT.10.20.20041	Anson	2	SR-1110 / MAYESVILLE RD ROUTE ID # 40001110004	FROM SR 1003 DEEP CREEK RD TO SOUTH CAROLINA STATE LINE MP 0.00 TO MP 4.55	2,3	2	2WU	4.55	17-20	0	4.55	510	0.85	97,096	90,427
TOTAL FOR MAP NO. 2							4.55					510	0.850	97,096	90,427
TOTAL FOR PROJ NO. 2025CPT.10.20.20041							5.13					575	1.000	109,544	102,875
GRAND TOTAL							5.13					575	1.000	109,544	102,875